

EZ LOK

THREADED INSERTS



For Strong Threads in Metal, Wood and Plastic



SOLID THREADED INSERTS FOR METAL.....3

CARBON STEEL 3

THIN WALL INSTALLATION KITS.....4

SCREW LOCKING INSERTS4

METRIC..... 5

AUTOTMOTIVE..... 5

STAINLESS STEEL (UNC/UNF/METRIC) 6

PREPACKAGED KITS..... 7

COIL THREADED INSERTS FOR METAL.....8

UNC FREE RUNNING 8

UNF FREE RUNNING..... 8

METRIC COARSE FREE RUNNING 9

METRIC FINE FREE RUNNING 9

SPARK PLUG 9

COIL INSERT THREAD REPAIR KITS 10

DRILLS, TAPS, INSTALL TOOLS AND TANG BREAKS 11

ULTRASONIC INSERTS 12

TAPERED 12

STRAIGHT 13

PRESS INSERTS FOR THERMOSET PLASTICS 14

KNIFE THREAD INSERTS FOR HARD WOOD 15

HEX DRIVE INSERTS FOR SOFT WOOD 15

FINSERTS FOR SOFT WOOD AND PLASTIC..... 16

STRONG THREADS MADE EASY

All solid construction E-Z LOK threaded inserts install with standard tools. No special drills...no special taps...no special installation tools.

E-Z LOK external threads are standard size and pitch to permit the use of standard drills and taps. E-Z LOKs can be installed with a screwdriver, bolt/jam nut (except IC series), or optional power drive tool.

E-Z LOKs will not back out or vibrate loose. Immediately upon installation, microencapsulated adhesive begins to set and the newly installed inserts are fastener-ready in 3-5 minutes.

The adhesive seals against liquids and gases to 6,000 psi when fully cured (72 hours).



Power drive tools are available for high volume installation... See insert tables for catalog numbers and sizes.

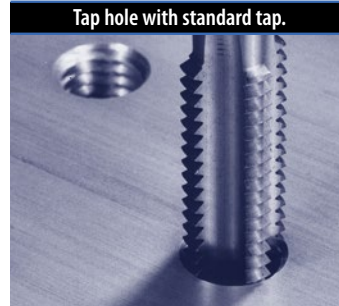

E-Z LOK CARBON STEEL INSERTS FOR METAL



COARSE THREAD SIZES

| EZ-LOK Part No. | Internal Thread | External Thread | Length in. | Tap Drill Size | Tap Size | Minimum Full Thread Depth | Drive Tool Catalog No. |
|-----------------|-----------------|-----------------|------------|----------------|----------|---------------------------|------------------------|
| 329-004 | 4-40 | 10-32 | .250 | 5/32 | 10-32 | 9/32 | — |
| 329-006 | 6-32 | 1/4-20 | .280 | 7 | 1/4-20 | 11/32 | 500-006 |
| 329-008 | 8-32 | 5/16-18 | .290 | F | 5/16-18 | 7/16 | 500-1 |
| 329-3 | 10-24 | 3/8-16 | .406 | 5/16 | 3/8-16 | 15/32 | 500-2 |
| 329-4 | 1/4-20 | 7/16-14 | .437 | 23/64 | 7/16-14 | 1/2 | 500-3 |
| 329-401 | 1/4-20 | 7/16-14 | 1.000 | 23/64 | 7/16-14 | 1-1/8 | 500-3 |
| 329-5 | 5/16-18 | 1/2-13 | .484 | 27/64 | 1/2-13 | 9/16 | 500-4 |
| 329-501 | 5/16-18 | 1/2-13 | 1.000 | 27/64 | 1/2-13 | 1-1/8 | 500-4 |
| 329-6 | 3/8-16 | 9/16-12 | .515 | 31/64 | 9/16-12 | 19/32 | 500-5 |
| 329-601 | 3/8-16 | 9/16-12 | 1.000 | 31/64 | 9/16-12 | 1-1/8 | 500-5 |
| 329-7 | 7/16-14 | 5/8-11 | .656 | 17/32 | 5/8-11 | 23/32 | 500-6 |
| 329-8 | 1/2-13 | 3/4-10 | .656 | 21/32 | 3/4-10 | 3/4 | 500-7 |
| 329-801 | 1/2-13 | 3/4-10 | 1.000 | 21/32 | 3/4-10 | 1-1/8 | 500-7 |
| 329-9 | 9/16-12 | 3/4-10 | .656 | 21/32 | 3/4-10 | 3/4 | 500-7 |
| 329-10 | 5/8-11 | 7/8-9 | .687 | 49/64 | 7/8-9 | 13/16 | 500-8 |
| 329-1018 | 5/8-11 | 7/8-9 | 1.125 | 49/64 | 7/8-9 | 1-1/4 | 500-8 |
| 329-12 | 3/4-10 | 1-8 | .781 | 7/8 | 1-8 | 7/8 | 500-9 |
| 329-14 | 7/8-9 | 1-1/4-7 | 1.125 | 1-7/64 | 1-1/4-7 | 1-1/4 | — |
| 329-16 | 1-8 | 1-3/8-12 | 1.250 | 1-9/32 | 1-3/8-12 | 1-3/8 | — |

FINE THREAD SIZES

| EZ-LOK Part No. | Internal Thread | External Thread | Length in. | Tap Drill Size | Tap Size | Minimum Full Thread Depth | Drive Tool Catalog No. |
|-----------------|-----------------|-----------------|------------|----------------|----------|---------------------------|------------------------|
| 329-332 | 10-32 | 3/8-16 | .406 | 5/16 | 3/8-16 | 15/32 | 500-2 |
| 329-428 | 1/4-28 | 7/16-14 | .437 | 23/64 | 7/16-14 | 1/2 | 500-3 |
| 329-524 | 5/16-24 | 1/2-13 | .484 | 27/64 | 1/2-13 | 9/16 | 500-4 |
| 329-624 | 3/8-24 | 9/16-12 | .515 | 31/64 | 9/16-12 | 19/32 | 500-5 |
| 329-720 | 7/16-20 | 5/8-11 | .656 | 17/32 | 5/8-11 | 23/32 | 500-6 |
| 329-820 | 1/2-20 | 3/4-10 | .656 | 21/32 | 3/4-10 | 3/4 | 500-7 |
| 329-918 | 9/16-18 | 3/4-10 | .656 | 21/32 | 3/4-10 | 3/4 | 500-7 |
| 329-10F | 5/8-18 | 7/8-9 | .687 | 49/64 | 7/8-9 | 13/16 | 500-8 |
| 329-1216 | 3/4-16 | 1-8 | .781 | 7/8 | 1-8 | 7/8 | 500-9 |
| 329-1414 | 7/8-14 | 1-1/4-7 | 1.125 | 1-7/64 | 1-1/4-7 | 1-1/4 | — |
| 329-1614 | 1-14 | 1-3/8-12 | 1.250 | 1-9/32 | 1-3/8-12 | 1-3/8 | — |



EXTRA HEAVY WALL — COARSE THREAD SIZES

| EZ-LOK Part No. | Internal Thread | External Thread | Length in. | Tap Drill Size | Tap Size | Minimum Full Thread Depth | Drive Tool Catalog No. |
|-----------------|-----------------|-----------------|------------|----------------|----------|---------------------------|------------------------|
| 335-4 | 1/4-20 | 1/2-13 | .484 | 27/64 | 1/2-13 | 9/16 | 500-3 |
| 335-5 | 5/16-18 | 9/16-12 | .515 | 31/64 | 9/16-12 | 19/32 | 500-4 |
| 335-6 | 3/8-16 | 5/8-11 | .656 | 17/32 | 5/8-11 | 23/32 | 500-5 |
| 335-8 | 1/2-13 | 7/8-9 | .687 | 49/64 | 7/8-9 | 13/16 | — |
| 335-10 | 5/8-11 | 1-8 | .781 | 7/8 | 1-8 | 7/8 | — |

THIN WALL — COARSE THREAD SIZES

| EZ-LOK Part No. | Internal Thread | External Thread | Length in. | Tap Drill Size | Tap Size | Minimum Full Thread Depth | Drive Tool Catalog No. |
|-----------------|-----------------|-----------------|------------|----------------|----------|---------------------------|------------------------|
| 319-3 | 10-24 | 5/16-18 | .312 | I | 5/16-18 | .375 | 500-2 |
| 319-4 | 1/4-20 | 3/8-16 | .375 | Q | 3/8-16 | .437 | 500-3 |
| 319-5 | 5/16-18 | 7/16-14 | .437 | X | 7/16-14 | .500 | 500-4 |
| 319-6 | 3/8-16 | 1/2-13 | .500 | 29/64 | 1/2-13 | .560 | 500-5 |
| 319-7 | 7/16-14 | 9/16-12 | .560 | 33/64 | 9/16-12 | .620 | 500-6 |
| 319-8 | 1/2-13 | 5/8-11 | .620 | 37/64 | 5/8-11 | .680 | 500-7 |

THIN WALL — FINE THREAD SIZES

| EZ-LOK Part No. | Internal Thread | External Thread | Length in. | Tap Drill Size | Tap Size | Minimum Full Thread Depth | Drive Tool Catalog No. |
|-----------------|-----------------|-----------------|------------|----------------|----------|---------------------------|------------------------|
| 319-332 | 10-32 | 5/16-18 | .312 | I | 5/16-18 | .375 | 500-2 |
| 319-428 | 1/4-28 | 3/8-16 | .375 | Q | 3/8-16 | .437 | 500-3 |
| 319-524 | 5/16-24 | 7/16-14 | .437 | X | 7/16-14 | .500 | 500-4 |
| 319-624 | 3/8-24 | 1/2-13 | .500 | 29/64 | 1/2-13 | .560 | 500-5 |
| 319-720 | 7/16-20 | 9/16-12 | .560 | 33/64 | 9/16-12 | .620 | 500-6 |
| 319-820 | 1/2-20 | 5/8-11 | .620 | 37/64 | 5/8-11 | .680 | 500-7 |

THIN WALL — METRIC THREAD SIZES

| EZ-LOK Part No. | Internal Thread | External Thread | Length in. | Tap Drill Size | Tap Size | Minimum Full Thread Depth | Drive Tool Catalog No. |
|-----------------|-----------------|-----------------|------------|----------------|----------|---------------------------|------------------------|
| 319-M4 | M4-0.7 | 5/16-18 | .312 | I | 5/16-18 | .375 | 500-2 |
| 319-M5 | M5-0.8 | 5/16-18 | .312 | I | 5/16-18 | .375 | 500-2 |
| 319-M6 | M6-1.0 | 3/8-16 | .375 | Q | 3/8-16 | .437 | 500-3 |
| 319-M8 | M8-1.25 | 7/16-14 | .437 | X | 7/16-14 | .500 | 500-4 |
| 319-M10 | M10-1.5 | 1/2-13 | .500 | 29/64 | 1/2-13 | .560 | 500-5 |
| 319-M12 | M12-1.75 | 5/8-11 | .620 | 37/64 | 5/8-11 | .680 | 500-7 |



THIN WALL INSTALLATION KITS

| Kit Part No. | Internal Thread | Kit Part No. | Internal Thread | Kit Part No. | Internal Thread |
|--------------|-----------------|--------------|-----------------|--------------|-----------------|
| EZ-319-3 | 10-24 | EZ-319-6 | 3/8-16 | EZ-319-M4 | M4-0.7 |
| EZ-319-332 | 10-32 | EZ-319-624 | 3/8-24 | EZ-319-M5 | M5-0.8 |
| EZ-319-4 | 1/4-20 | EZ-319-7 | 7/16-14 | EZ-319-M6 | M6-1.0 |
| EZ-319-428 | 1/4-28 | EZ-319-720 | 7/16-20 | EZ-319-M8 | M8-1.25 |
| EZ-319-5 | 5/16-18 | EZ-319-8 | 1/2-13 | EZ-319-M10 | M10-1.5 |
| EZ-319-524 | 5/16-24 | EZ-319-820 | 1/2-20 | EZ-319-M12 | M12-1.75 |

Each kit includes 20 inserts plus a drill, tap, and installation tool.

SCREW-LOCKING INSERTS

These are our standard heavy wall inserts with thread locking adhesive applied to the internal threads providing a permanent screw-locking feature. The adhesive activates when a fastener is threaded into the insert. Install these inserts with a screwdriver or drive tool, allowing 3-5 minutes for the external thread adhesive to set-up prior to threading in the fastener. A bolt can be used for installation as long as you do not intend to remove it. Removing the bolt after installation destroys adhesive effectiveness.

| EZ-LOK Part No. | Internal Thread | External Thread | Length in. | Tap Drill Size | Tap Size | Minimum Full Thread Depth | Drive Tool Catalog No. |
|-----------------|-----------------|-----------------|------------|----------------|----------|---------------------------|------------------------|
| 329-3-IC | 10-24 | 3/8-16 | .406 | 5/16 | 3/8-16 | 15/32 | 500-2 |
| 329-332-IC | 10-32 | 3/8-16 | .406 | 5/16 | 3/8-16 | 15/32 | 500-2 |
| 329-4-IC | 1/4-20 | 7/16-14 | .437 | 23/64 | 7/16-14 | 1/2 | 500-3 |
| 329-5-IC | 5/16-18 | 1/2-13 | .484 | 27/64 | 1/2-13 | 9/16 | 500-4 |
| 329-6-IC | 3/8-16 | 9/16-12 | .515 | 31/64 | 9/16-12 | 19/32 | 500-5 |
| 329-8-IC | 1/2-13 | 3/4-10 | .656 | 21/32 | 3/4-10 | 3/4 | 500-7 |



CARBON STEEL INSERTS FOR METAL



METRIC THREAD SIZES — METRIC INTERNAL/METRIC EXTERNAL

| EZ-LOK Part No. | Internal Thread | External Thread | Length | Tap Drill Size | Tap Size | Minimum Full Thread Depth | Drive Tool Catalog No. |
|-----------------|-----------------|-----------------|--------|----------------|----------|---------------------------|------------------------|
| 450-3 | M3-0.5 | M6-1.0 | 6.5mm | 5.1mm | M6-1.0 | 7.8mm | — |
| 450-4 | M4-0.7 | M8-1.25 | 7.5mm | 6.9mm | M8-1.25 | 9.0mm | 500-1 |
| 450-5 | M5-0.8 | M8-1.25 | 7.5mm | 6.9mm | M8-1.25 | 9.0mm | 500-1 |
| 450-6 | M6-1.0 | M10-1.5 | 10.5mm | 8.6mm | M10-1.5 | 12.0mm | 500-3 |
| 450-8 | M8-1.25 | M12-1.75 | 12.5mm | 10.4mm | M12-1.75 | 14.5mm | 500-4 |
| 450-10 | M10-1.5 | M16-2.0 | 17.0mm | 14.0mm | M16-2.0 | 19.0mm | 500-5 |
| 450-12 | M12-1.75 | M16-2.0 | 17.0mm | 14.0mm | M16-2.0 | 19.0mm | 500-6 |
| 450-16 | M16-2.0 | M24-3.0 | 20.0mm | 21.0mm | M24-3.0 | 24.0mm | 500-8 |
| 450-20 | M20-2.5 | M36-4.0 | 30.0mm | 33.0mm | M36-4.0 | 35.0mm | — |
| 450-24 | M24-3.0 | M36-4.0 | 30.0mm | 33.0mm | M36-4.0 | 35.0mm | — |

METRIC THREAD SIZES — U.S. INTERNAL/METRIC EXTERNAL

| EZ-LOK Part No. | Internal Thread | External Thread | Length (in.) | Tap Drill Size | Tap Size | Minimum Full Thread Depth | Drive Tool Catalog No. |
|-----------------|-----------------|-----------------|--------------|----------------|----------|---------------------------|------------------------|
| 550-006 | 6-32 | M6-1.0 | .256 | 5.1mm | M6-1.0 | 7.8mm | 500-006 |
| 550-008 | 8-32 | M8-1.25 | .295 | 6.9mm | M8-1.25 | 9.0mm | 500-1 |
| 550-1024 | 10-24 | M8-1.25 | .295 | 6.9mm | M8-1.25 | 12.0mm | 500-2 |
| 550-1032 | 10-32 | M8-1.25 | .295 | 6.9mm | M8-1.25 | 12.0mm | 500-2 |
| 550-1420 | 1/4-20 | M10-1.5 | .413 | 8.6mm | M10-1.5 | 14.5mm | 500-3 |
| 550-5 | 5/16-18 | M12-1.75 | .492 | 10.4mm | M12-1.75 | 14.5mm | 500-4 |
| 550-6 | 3/8-16 | M16-2.0 | .669 | 14.0mm | M16-2.0 | 19.0mm | 500-5 |
| 550-8 | 1/2-13 | M16-2.0 | .669 | 14.0mm | M16-2.0 | 19.0mm | 500-7 |

METRIC THREAD SIZES — METRIC INTERNAL/U.S. EXTERNAL

| EZ-LOK Part No. | Internal Thread | External Thread | Length | Tap Drill Size | Tap Size | Minimum Full Thread Depth | Drive Tool Catalog No. |
|-----------------|-----------------|-----------------|--------|----------------|----------|---------------------------|------------------------|
| 650-6 | M6-1.0 | 3/8-16 | .406 | 5/16 | 3/8-16 | 15/32 | 500-3 |
| 650-8 | M8-1.25 | 1/2-13 | .484 | 27/64 | 1/2-13 | 9/16 | 500-4 |
| 650-10 | M10-1.50 | 9/16-12 | .515 | 31/64 | 9/16-12 | 19/32 | 500-5 |
| 650-10F | M10-1.25 | 9/16-12 | .515 | 31/64 | 9/16-12 | 19/32 | 500-5 |
| 650-12 | M12-1.75 | 3/4-10 | .656 | 21/32 | 3/4-10 | 3/4 | 500-6 |
| 650-14 | M14-2.0 | 7/8-9 | .687 | 49/64 | 7/8-9 | 13/16 | 500-7 |
| 650-16 | M16-2.0 | 1-8 | .781 | 7/8 | 1-8 | 7-8 | 500-8 |



CARBON STEEL INSERTS — AUTOMOTIVE



AUTOMOTIVE DESIGNS

| EZ-LOK Part No. | Internal Thread | External Thread | Length | Tap Drill Size | Tap Size |
|-------------------------|-----------------|-----------------|--------|----------------|----------|
| SPARK PLUG SIZES | | | | | |
| 329-1008 | M10 -1.0 | 9/16-18 | .453 | 33/64 | 9/16-18 |
| 329-1208 | M12-1.25 | 5/8-18 | .453 | 37/64 | 5/8-18 |
| 329-1212 | M12-1.25 | 5/8-18 | .703 | 37/64 | 5/8-18 |
| 750-14 | M14 -1.25 | M18-1.5 | 11.5mm | 16.5mm | M18-1.5 |
| 329-1406 | M14 -1.25 | 3/4-16 | .328 | 11/16 | 3/4-16 |
| 329-1408 | M14 -1.25 | 3/4-16 | .453 | 11/16 | 3/4-16 |
| 329-1412 | M14 -1.25 | 3/4-16 | .703 | 11/16 | 3/4-16 |
| 329-1808 | M18-1.5 | 1-12 | .453 | 59/64 | 1-12 |
| VW CASE SAVERS | | | | | |
| 330-10 (Open) | M10-1.50 | 9/16-12 | 1.000 | 31/64 | 9/16-12 |
| 330-11 (Closed) | M10-1.50 | 9/16-12 | 1.000 | 31/64 | 9/16-12 |



COARSE THREAD SIZES IN 303 STAINLESS STEEL

| EZ-LOK Part No. | Internal Thread | External Thread | Length in. | Tap Drill Size | Tap Size | Minimum Full Thread Depth | Drive Tool Catalog No. |
|-----------------|-----------------|-----------------|------------|----------------|----------|---------------------------|------------------------|
| 303-004 | 4-40 | 10-32 | .250 | 5/32 | 10-32 | 9/32 | — |
| 303-006 | 6-32 | 1/4-20 | .280 | 7 | 1/4-20 | 11/32 | — |
| 303-008 | 8-32 | 5/16-18 | .290 | F | 5/16-18 | 7/16 | 500-1 |
| 303-3 | 10-24 | 3/8-16 | .406 | 5/16 | 3/8-16 | 15/32 | 500-2 |
| 303-4 | 1/4-20 | 7/16-14 | .437 | 23/64 | 7/16-14 | 1/2 | 500-3 |
| 303-5 | 5/16-18 | 1/2-13 | .484 | 27/64 | 1/2-13 | 9/16 | 500-4 |
| 303-6 | 3/8-16 | 9/16-12 | .515 | 31/64 | 9/16-12 | 19/32 | 500-5 |
| 303-7 | 7/16-14 | 5/8-11 | .656 | 17/32 | 5/8-11 | 23/32 | 500-6 |
| 303-8 | 1/2-13 | 3/4-10 | .656 | 21/32 | 3/4-10 | 3/4 | 500-7 |
| 303-10 | 5/8-11 | 7/8-9 | .687 | 49/64 | 7/8-9 | 13/16 | 500-8 |
| 303-12 | 3/4-10 | 1-8 | .781 | 7/8 | 1-8 | 7/8 | 500-9 |

FINE THREAD SIZES IN 303 STAINLESS STEEL

| EZ-LOK Part No. | Internal Thread | External Thread | Length in. | Tap Drill Size | Tap Size | Minimum Full Thread Depth | Drive Tool Catalog No. |
|-----------------|-----------------|-----------------|------------|----------------|----------|---------------------------|------------------------|
| 303-332 | 10-32 | 3/8-16 | .406 | 5/16 | 3/8-16 | 15/32 | 500-2 |
| 303-428 | 1/4-28 | 7/16-14 | .437 | 23/64 | 7/16-14 | 1/2 | 500-3 |
| 303-524 | 5/16-24 | 1/2-13 | .484 | 27/64 | 1/2-13 | 9/16 | 500-4 |
| 303-624 | 3/8-24 | 9/16-12 | .515 | 31/64 | 9/16-12 | 19/32 | 500-5 |
| 303-720 | 7/16-20 | 5/8-11 | .656 | 17/32 | 5/8-11 | 23/32 | 500-6 |
| 303-820 | 1/2-20 | 3/4-10 | .656 | 21/32 | 3/4-10 | 3/4 | 500-7 |

METRIC THREAD SIZES IN 303 STAINLESS STEEL — METRIC INTERNAL/METRIC EXTERNAL

| EZ-LOK Part No. | Internal Thread | External Thread | Length | Tap Drill Size | Tap Size | Minimum Full Thread Depth | Drive Tool Catalog No. |
|-----------------|-----------------|-----------------|--------|----------------|----------|---------------------------|------------------------|
| 453-3 | M3-0.5 | M6-1.0 | 6.5mm | 5.1mm | M6-1.0 | 7.8mm | — |
| 453-4 | M4-0.7 | M8-1.25 | 7.5mm | 6.9mm | M8-1.25 | 9.0mm | 500-1 |
| 453-5 | M5-0.8 | M8-1.25 | 7.5mm | 6.9mm | M8-1.25 | 9.0mm | 500-1 |
| 453-6 | M6-1.0 | M10-1.5 | 10.5mm | 8.6mm | M10-1.5 | 12.0mm | 500-3 |
| 453-8 | M8-1.25 | M12-1.75 | 12.5mm | 10.4mm | M12-1.75 | 14.5mm | 500-4 |
| 453-10 | M10-1.5 | M16-2.0 | 17.0mm | 14.0mm | M16-2.0 | 19.0mm | 500-5 |
| 453-12 | M12-1.75 | M16-2.0 | 17.0mm | 14.0mm | M16-2.0 | 19.0mm | 500-6 |
| 453-16 | M16-2.0 | M24-3.0 | 20.0mm | 21.0mm | M24-3.0 | 24.0mm | 500-8 |

METRIC THREAD SIZES IN 303 STAINLESS STEEL — METRIC INTERNAL/U.S. EXTERNAL

| EZ-LOK Part No. | Internal Thread | External Thread | Length | Tap Drill Size | Tap Size | Minimum Full Thread Depth | Drive Tool Catalog No. |
|-----------------|-----------------|-----------------|--------|----------------|----------|---------------------------|------------------------|
| 653-6 | M6-1.0 | 3/8-16 | .406 | 5/16 | 3/8-16 | 15/32 | 500-3 |
| 653-8 | M8-1.25 | 1/2-13 | .484 | 27/64 | 1/2-13 | 9/16 | 500-4 |
| 653-10 | M10-1.50 | 9/16-12 | .515 | 31/64 | 9/16-12 | 19/32 | 500-5 |
| 653-10F | M10-1.25 | 9/16-12 | .515 | 31/64 | 9/16-12 | 19/32 | 500-5 |
| 653-12 | M12-1.75 | 3/4-10 | .656 | 21/32 | 3/4-10 | 3/4 | 500-6 |
| 653-14 | M14-2.0 | 7/8-9 | .687 | 49/64 | 7/8-9 | 13/16 | 500-7 |
| 653-16 | M16-2.0 | 1-8 | .781 | 7/8 | 1-8 | 7/8 | 500-8 |

COARSE/FINE THREAD SIZES IN 316 STAINLESS STEEL

| EZ-LOK Part No. | Internal Thread | External Thread | Length in. | Tap Drill Size | Tap Size | Minimum Full Thread Depth | Drive Tool Catalog No. |
|-----------------|-----------------|-----------------|------------|----------------|----------|---------------------------|------------------------|
| 316-008 | 8-32 | 5/16-18 | .290 | F | 5/16-18 | 7/16 | 500-1 |
| 316-3 | 10-24 | 3/8-16 | .406 | 5/16 | 3/8-16 | 15/32 | 500-2 |
| 316-332 | 10-32 | 3/8-16 | .406 | 5/16 | 3/8-16 | 15/32 | 500-2 |
| 316-4 | 1/4-20 | 7/16-14 | .437 | 23/64 | 7/16-14 | 1.125 | 500-3 |
| 316-5 | 5/16-18 | 1/2-13 | .484 | 27/64 | 1/2-13 | 1.125 | 500-4 |
| 316-6 | 3/8-16 | 9/16-12 | .515 | 31/64 | 9/16-12 | 1.125 | 500-5 |

E-Z LOK PREPACKAGED KITS — THREAD INSERTS FOR METAL



Prepackaged kits containing a range of sizes are available.

Note: Because E-Z LOK inserts install with standard tools, our kits contain only inserts. Drills and taps are not included.



| CARBON STEEL THREAD INSERTS FOR METAL | | | | | |
|---------------------------------------|------------|---------------------|--------------------|-----------------|-----------------|
| Kit Type | Kit Number | Quantity of Inserts | Insert Part Number | Internal Thread | External Thread |
| Coarse Thread #10 to 7/16" | EZ C107 | 10 | 329-3 | 10-24 | 3/8-16 |
| | | 10 | 329-4 | 1/4-20 | 7/16-14 |
| | | 10 | 329-5 | 5/16-18 | 1/2-13 |
| | | 10 | 329-6 | 3/8-16 | 9/16-12 |
| | | 8 | 329-7 | 7/16-14 | 5/8-11 |
| Coarse Thread #10 to 1/2" | EZ C108 | 10 | 329-3 | 10-24 | 3/8-16 |
| | | 10 | 329-4 | 1/4-20 | 7/16-14 |
| | | 10 | 329-5 | 5/16-18 | 1/2-13 |
| | | 10 | 329-6 | 3/8-16 | 9/16-12 |
| | | 6 | 329-8 | 1/2-13 | 3/4-10 |
| Coarse Thread 1/2" to 1" | EZ C816 | 6 | 329-8 | 1/2-13 | 3/4-10 |
| | | 7 | 329-10 | 5/8-11 | 7/8-9 |
| | | 7 | 329-12 | 3/4-10 | 1-8 |
| | | 2 | 329-16 | 1-8 | 1-3/8-12 |
| Fine Thread #10 to 7/16" | EZ F107 | 10 | 329-332 | 10-32 | 3/8-16 |
| | | 10 | 329-428 | 1/4-28 | 7/16-14 |
| | | 10 | 329-524 | 5/16-24 | 1/2-13 |
| | | 10 | 329-624 | 3/8-24 | 9/16-12 |
| | | 8 | 329-720 | 7/16-20 | 5/8-11 |
| Fine Thread #10 to 1/2" | EZ F108 | 10 | 329-332 | 10-32 | 3/8-16 |
| | | 10 | 329-428 | 1/4-28 | 7/16-14 |
| | | 10 | 329-524 | 5/16-24 | 1/2-13 |
| | | 10 | 329-624 | 3/8-24 | 9/16-12 |
| | | 6 | 329-820 | 1/2-20 | 3/4-10 |
| Fine Thread 1/2" to 1" | EZ F816 | 6 | 329-820 | 1/2-20 | 3/4-10 |
| | | 7 | 329-10F | 5/8-18 | 7/8-9 |
| | | 7 | 329-1216 | 3/4-16 | 1-8 |
| | | 2 | 329-1614 | 1-14 | 1-3/8-12 |

| CARBON STEEL THREAD INSERTS FOR METAL — METRIC | | | | | |
|--|------------|---------------------|--------------------|-----------------|-----------------|
| Kit Type | Kit Number | Quantity of Inserts | Insert Part Number | Internal Thread | External Thread |
| Metric Thread M3 to M8 | EZ M100 | 10 | 450-3 | M3-0.5 | M6-1.0 |
| | | 10 | 450-4 | M4-0.7 | M8-1.25 |
| | | 10 | 450-5 | M5-0.8 | M8-1.25 |
| | | 10 | 450-6 | M6-1.0 | M10-1.5 |
| | | 10 | 450-8 | M8-1.25 | M12-1.75 |
| Metric Thread M8 to M16 | EZ M200 | 10 | 450-8 | M8-1.25 | M12-1.75 |
| | | 10 | 450-10 | M10-1.5 | M16-2.0 |
| | | 8 | 450-12 | M12-1.75 | M16-2.0 |
| | | 5 | 450-16 | M16-2.0 | M24-3.0 |
| Coarse Thread #10 to 1/2" | EZ M508 | 10 | 550-3 | 10-24 | M10-1.5 |
| | | 10 | 550-4 | 1/4-20 | M12-1.75 |
| | | 10 | 550-5 | 5/16-18 | M12-1.75 |
| | | 10 | 550-6 | 3/8-16 | M16-2.0 |
| | | 6 | 550-8 | 1/2-13 | M16-2.0 |
| | | 10 | 650-6 | M6-1.0 | 3/8-16 |
| Metric Thread M6 to M12 | EZ M612 | 10 | 650-8 | M8-1.25 | 1/2-13 |
| | | 10 | 650-10 | M10-1.5 | 9/16-12 |
| | | 10 | 650-10 | M10-1.5 | 9/16-12 |
| | | 6 | 650-12 | M12-1.75 | 3/4-10 |

| STAINLESS STEEL THREAD INSERTS FOR METAL | | | | | |
|--|------------|---------------------|--------------------|-----------------|-----------------|
| Kit Type | Kit Number | Quantity of Inserts | Insert Part Number | Internal Thread | External Thread |
| Coarse Thread 303 Stainless #10 to 1/2" | EZ C303 | 10 | 303-3 | 10-24 | 3/8-16 |
| | | 10 | 303-4 | 1/4-20 | 7/16-14 |
| | | 10 | 303-5 | 5/16-18 | 1/2-13 |
| | | 10 | 303-6 | 3/8-16 | 9/16-12 |
| | | 6 | 303-8 | 1/2-13 | 3/4-10 |
| Fine Thread 303 Stainless #10 to 1/2" | EZ F303 | 10 | 303-332 | 10-32 | 3/8-16 |
| | | 10 | 303-428 | 1/4-28 | 7/16-14 |
| | | 10 | 303-524 | 5/16-24 | 1/2-13 |
| | | 10 | 303-624 | 3/8-24 | 9/16-12 |
| | | 6 | 303-820 | 1/2-20 | 3/4-10 |
| Metric Thread 303 Stainless M3 to M8 | EZ M103 | 10 | 453-3 | M3-0.5 | M6-1.0 |
| | | 10 | 453-4 | M4-0.7 | M8-1.25 |
| | | 10 | 453-5 | M5-0.8 | M8-1.25 |
| | | 10 | 453-6 | M6-1.0 | M10-1.5 |
| | | 10 | 453-8 | M8-1.25 | M12-1.75 |
| Metric Thread 303 Stainless M8 to M16 | EZ M203 | 10 | 453-8 | M8-1.25 | M12-1.75 |
| | | 10 | 453-10 | M10-1.5 | M16-2.0 |
| | | 8 | 453-12 | M12-1.75 | M16-2.0 |
| | | 5 | 453-16 | M16-2.0 | M24-3.0 |
| | | 10 | 653-6 | M6-1.0 | 3/8-16 |
| Metric Thread 303 Stainless M6 to M12 | EZ M613 | 10 | 653-8 | M8-1.25 | 1/2-13 |
| | | 10 | 653-10 | M10-1.5 | 9/16-12 |
| | | 10 | 653-10 | M10-1.5 | 9/16-12 |
| | | 6 | 653-12 | M12-1.75 | 3/4-10 |



| UNC • FREERUNNING | | | | | | | | | | | |
|-------------------|----------|-----------|----------|-----------|----------|-----------|----------|-------|----------|---------|------------------------|
| Internal Thread | 1D | | 1.5D | | 2D | | Free O/D | | Drill | | STI Tap (Intermediate) |
| | Part No. | Lgth (in) | Part No. | Lgth (in) | Part No. | Lgth (in) | Min | Max | Part No. | Size | |
| 2-56 | 20010 | 0.086 | 20015 | 0.129 | 20020 | 0.172 | 0.109 | 0.113 | 20060 | 3/32 | 20070 |
| 3-48 | 20110 | 0.099 | 20115 | 0.148 | 20120 | 0.198 | 0.126 | 0.134 | 20160 | #36 | 20170 |
| 4-40 | 20210 | 0.112 | 20215 | 0.168 | 20220 | 0.224 | 0.144 | 0.149 | A0260 | #31 | 20270 |
| 5-40 | 20310 | 0.125 | 20315 | 0.188 | 20320 | 0.250 | 0.157 | 0.165 | 20360 | #29 | 20370 |
| 6-32 | 20410 | 0.138 | 20415 | 0.207 | 20420 | 0.276 | 0.178 | 0.183 | A0460 | #25 | 20470 |
| 8-32 | 20510 | 0.164 | 20515 | 0.246 | 20520 | 0.328 | 0.205 | 0.210 | A0560 | 11/64 | 20570 |
| 10-24 | 20610 | 0.190 | 20615 | 0.285 | 20620 | 0.380 | 0.240 | 0.248 | A0660 | 13/64 | 20670 |
| 12-24 | 20710 | 0.216 | 20715 | 0.324 | 20720 | 0.432 | 0.268 | 0.275 | 20760 | 15/64 | 20770 |
| 1/4-20 | 20810 | 0.250 | 20815 | 0.375 | 20820 | 0.500 | 0.314 | 0.322 | A0860 | 17/64 | 20870 |
| 5/16-18 | 20910 | 0.313 | 20915 | 0.469 | 20920 | 0.625 | 0.384 | 0.392 | A0960 | 21/64 | 20970 |
| 3/8-16 | 21010 | 0.375 | 21015 | 0.563 | 21020 | 0.750 | 0.455 | 0.463 | A1060 | 25/64 | 21070 |
| 7/16-14 | 21110 | 0.438 | 21115 | 0.656 | 21120 | 0.875 | 0.530 | 0.538 | A1160 | 29/64 | 21170 |
| 1/2-13 | 21210 | 0.500 | 21215 | 0.750 | 21220 | 1.000 | 0.600 | 0.610 | A1260 | 33/64 | 21270 |
| 9/16-12 | 21310 | 0.563 | 21315 | 0.844 | 21320 | 1.125 | 0.667 | 0.679 | A1360 | 37/64 | 21370 |
| 5/8-11 | 21410 | 0.625 | 21415 | 0.938 | 21420 | 1.250 | 0.742 | 0.752 | 21460 | 21/32 | 21470 |
| 3/4-10 | 21510 | 0.750 | 21515 | 1.125 | 21520 | 1.500 | 0.880 | 0.892 | 21560 | 25/32 | 21570 |
| 7/8-9 | 21610 | 0.875 | 21615 | 1.313 | 21620 | 1.750 | 1.019 | 1.033 | 21660 | 29/32 | 21670 |
| 1-8 | 21710 | 1.000 | 21715 | 1.500 | 21720 | 2.000 | 1.162 | 1.179 | 21760 | 1-1/32 | 21770 |
| 1-1/8-7 | 21810* | 1.125 | 21815 | 1.688 | 21820* | 2.250 | 1.315 | 1.355 | A1860 | 1-5/32 | 21870 |
| 1-1/4-7 | 21910* | 1.250 | 21915 | 1.875 | 21920* | 2.500 | 1.443 | 1.483 | A1960 | 1-9/32 | 21970 |
| 1-3/8-6 | 22010* | 1.375 | 22015 | 2.063 | 22020* | 2.750 | 1.598 | 1.643 | A2060 | 1-13/32 | 22070 |
| 1-1/2-6 | 22110* | 1.500 | 22115 | 2.250 | 22120* | 3.000 | 1.716 | 1.728 | A2160 | 1-17/32 | 22170 |

| UNF • FREERUNNING | | | | | | | | | | | |
|-------------------|----------|-----------|----------|-----------|----------|-----------|----------|-------|----------|---------|------------------------|
| Internal Thread | 1D | | 1.5D | | 2D | | Free O/D | | Drill | | STI Tap (Intermediate) |
| | Part No. | Lgth (in) | Part No. | Lgth (in) | Part No. | Lgth (in) | Min | Max | Part No. | Size | |
| 4-48 | 30210 | 0.112 | 30215 | 0.168 | 30220 | 0.224 | 0.139 | 0.147 | A0260 | #31 | 30270 |
| 6-40 | 30410 | 0.138 | 30415 | 0.207 | 30420 | 0.276 | 0.170 | 0.178 | A0460 | #25 | 30470 |
| 8-36 | 30510 | 0.164 | 30515 | 0.246 | 30520 | 0.328 | 0.200 | 0.208 | A0560 | 11/64 | 30570 |
| 10-32 | 30610 | 0.190 | 30615 | 0.285 | 30620 | 0.380 | 0.233 | 0.241 | A0660 | 13/64 | 30670 |
| 1/4-28 | 30810 | 0.250 | 30815 | 0.375 | 30820 | 0.500 | 0.299 | 0.307 | A0860 | 17/64 | 30870 |
| 5/16-24 | 30910 | 0.313 | 30915 | 0.469 | 30920 | 0.625 | 0.370 | 0.378 | A0960 | 21/64 | 30970 |
| 3/8-24 | 31010 | 0.375 | 31015 | 0.563 | 31020 | 0.750 | 0.433 | 0.441 | A1060 | 25/64 | 31070 |
| 7/16-20 | 31110 | 0.438 | 31115 | 0.656 | 31120 | 0.875 | 0.507 | 0.515 | A1160 | 29/64 | 31170 |
| 1/2-20 | 31210 | 0.500 | 31215 | 0.750 | 31220 | 1.000 | 0.567 | 0.577 | A1260 | 33/64 | 31270 |
| 9/16-18 | 31310 | 0.563 | 31315 | 0.844 | 31320 | 1.125 | 0.630 | 0.642 | A1360 | 37/64 | 31370 |
| 5/8-18 | 31410 | 0.625 | 31415 | 0.938 | 31420 | 1.250 | 0.694 | 0.706 | 31460 | 41/64 | 31470 |
| 3/4-16 | 31510 | 0.750 | 31515 | 1.125 | 31520 | 1.500 | 0.831 | 0.841 | 31560 | 49/64 | 31570 |
| 7/8-14 | 31610 | 0.875 | 31615 | 1.313 | 31620 | 1.750 | 0.968 | 0.983 | 31660 | 57/64 | 31670 |
| 1-12 | 32210 | 1.000 | 32215 | 1.500 | 32220 | 2.000 | 1.108 | 1.120 | 31760 | 1-1/64 | 32270 |
| 1-14 | 31710 | 1.000 | 31715 | 1.500 | 31720 | 2.000 | 1.097 | 1.110 | 31760 | 1-1/64 | 31770 |
| 1-1/8-12 | 31810* | 1.125 | 31815 | 1.688 | 31820* | 2.250 | 1.304 | 1.334 | A1860 | 1-5/32 | 31870 |
| 1-1/4-12 | 31910* | 1.250 | 31915 | 1.875 | 31920* | 2.500 | 1.439 | 1.469 | A1960 | 1-9/32 | 31970 |
| 1-3/8-12 | 32010* | 1.375 | 32015 | 2.063 | 32020* | 2.750 | 1.575 | 1.610 | A2060 | 1-13/32 | 32070 |
| 1-1/2-12 | 32110* | 1.500 | 32115 | 2.250 | 32120* | 3.000 | 1.710 | 1.745 | A2160 | 1-17/32 | 32170 |

* Non-stock item



METRIC COARSE - FREERUNNING

| Internal Thread | 1D | | 1.5D | | 2D | | Free O/D | | Drill | | STI Tap (Intermediate) |
|-----------------|----------|-----------|----------|-----------|----------|-----------|----------|------|----------|-------|------------------------|
| | Part No. | Lgth (mm) | Part No. | Lgth (mm) | Part No. | Lgth (mm) | Min | Max | Part No. | Size | |
| M2 x 0.4 | 40010 | 2 | 40015 | 3 | 40020 | 4 | 2.5 | 2.6 | 40060 | 2.10 | 40070 |
| M2.5 X 0.45 | 40110 | 2.5 | 40115 | 3.75 | 40120 | 5 | 3.1 | 3.2 | 40160 | 2.60 | 40170 |
| M3 X 0.5 | 40210 | 3 | 40215 | 4.5 | 40220 | 6 | 3.6 | 3.7 | 40260 | 3.10 | 40270 |
| M3.5 X 0.6 | 40310 | 3.5 | 40315 | 5.25 | 40320 | 7 | 4.3 | 4.5 | 40360 | 3.60 | 40370 |
| M4 X 0.7 | 40410 | 4 | 40415 | 6 | 40420 | 8 | 4.8 | 4.9 | 40460 | 4.10 | 40470 |
| M5 X 0.8 | 40510 | 5 | 40515 | 7.5 | 40520 | 10 | 6.0 | 6.2 | 40560 | 5.20 | 40570 |
| M6 X 1.0 | 40610 | 6 | 40615 | 9 | 40620 | 12 | 7.3 | 7.4 | 40660 | 6.20 | 40670 |
| M7 X 1.0 | 40710 | 7 | 40715 | 10.5 | 40720 | 14 | 8.3 | 8.6 | 40760 | 7.20 | 40770 |
| M8 X 1.25 | 40810 | 8 | 40815 | 12 | 40820 | 16 | 9.7 | 9.9 | E0860 | 8.30 | 40870 |
| M10 X 1.5 | 40910 | 10 | 40915 | 15 | 40920 | 20 | 11.9 | 12.1 | E0960 | 10.30 | 40970 |
| M11 X 1.5 | 42210 | 11 | 42215 | 16.5 | 42220 | 22 | 13.0 | 13.3 | 42260 | 11.30 | 42270 |
| M12 X 1.75 | 41010 | 12 | 41015 | 18 | 41020 | 24 | 14.3 | 14.5 | E1060 | 12.40 | 41070 |
| M14 X 2.0 | 41110 | 14 | 41115 | 21 | 41120 | 28 | 16.6 | 17.0 | 41160 | 14.50 | 41170 |
| M16 X 2.0 | 41210 | 16 | 41215 | 24 | 41220 | 32 | 18.6 | 18.9 | 41260 | 16.50 | 41270 |
| M18 X 2.5 | 41310 | 18 | 41315 | 27 | 41320 | 36 | 21.2 | 21.6 | E1360 | 18.50 | 41370 |
| M20 X 2.5 | 41410 | 20 | 41415 | 30 | 41420 | 40 | 23.2 | 23.6 | E1460 | 20.50 | 41470 |
| M22 X 2.5 | 41510 | 22 | 41515 | 33 | 41520 | 44 | 25.3 | 25.6 | E1560 | 22.50 | 41570 |
| M24 X 3.0 | 41610 | 24 | 41615 | 36 | 41620 | 48 | 27.9 | 28.4 | 41660 | 24.75 | 41670 |
| M27 X 3.0 | 41710* | 27 | 41715 | 40.5 | 41720* | 54 | 30.9 | 31.4 | 41760 | 27.50 | 41770 |
| M30 X 3.5 | 41810* | 30 | 41815 | 45 | 41820* | 60 | 34.3 | 35.1 | 41860 | 30.50 | 41870 |
| M33 X 3.5 | 41910* | 33 | 41915 | 49.5 | 41920* | 66 | 37.5 | 37.9 | 41960 | 33.50 | 41970 |
| M36 X 4.0 | 42010* | 36 | 42015 | 54 | 42020* | 72 | 41.2 | 41.7 | 42060 | 36.50 | 42070 |
| M39 X 4.0 | 42110* | 39 | 42115 | 58.5 | 42120* | 78 | 44.2 | 44.6 | 42160 | 39.50 | 42170 |

METRIC FINE - FREERUNNING

| Internal Thread | 1D | | 1.5D | | 2D | | Free O/D | | Drill | | STI Tap (Intermediate) |
|-----------------|----------|-----------|----------|-----------|----------|-----------|----------|------|----------|-------|------------------------|
| | Part No. | Lgth (mm) | Part No. | Lgth (mm) | Part No. | Lgth (mm) | Min | Max | Part No. | Size | |
| M8 X 1.0 | 50810 | 8 | 50815 | 12 | 50820 | 16 | 9.3 | 9.6 | E0860 | 8.30 | 50870 |
| M10 X 1.25 | 50910 | 10 | 50915 | 15 | 50920 | 20 | 11.6 | 11.9 | E0960 | 10.30 | 50970 |
| M12 X 1.5 | 51010 | 12 | 51015 | 18 | 51020 | 24 | 13.9 | 14.3 | E1060 | 12.40 | 51070 |
| M14 X 1.5 | 51110 | 14 | 51115 | 21 | 51120 | 28 | 16.0 | 16.3 | E1160 | 14.30 | 51170 |
| M16 X 1.5 | 51210 | 16 | 51215 | 24 | 51220 | 32 | 18.0 | 18.3 | 51260 | 16.25 | 51270 |
| M18 X 2.0 | 51310* | 18 | 51315 | 27 | 51320* | 36 | 20.6 | 20.9 | E1360 | 18.50 | 51370 |
| M20 X 2.0 | 51410* | 20 | 51415 | 30 | 51420* | 40 | 22.6 | 23.0 | E1460 | 20.50 | 51470 |
| M22 X 2.0 | 51510* | 22 | 51515 | 33 | 51520* | 44 | 24.6 | 25.0 | E1560 | 22.50 | 51570 |
| M24 X 2.0 | 51610* | 24 | 51615 | 36 | 51620* | 48 | 26.6 | 27.1 | 51660 | 24.25 | 51670 |

SPARK PLUG

| Internal Thread | REACH | | | | | | Free O/D | | Drill | | STI Tap (Intermediate) |
|-----------------|--------------|--------------|---------------|--------------|--------------|--------------|----------|------|----------|-------|------------------------|
| | 1/4 Part No. | 3/8 Part No. | 7/16 Part No. | 1/2 Part No. | 5/8 Part No. | 3/4 Part No. | Min | Max | Part No. | Size | |
| M10-1.0 | 50931 | 50932 | 50933 | 50934 | NA | 50936 | 11.2 | 11.4 | E0960 | 10.30 | 50975 |
| M12-1.25 | NA | NA | NA | 51034 | NA | 51036 | 13.6 | 13.9 | E1060 | 12.40 | 51075 |
| M14-1.25 | NA | 51132 | 51133 | 51134 | 51135 | 51136 | 15.6 | 15.9 | E1160 | 14.30 | 51175 |
| M18-1.5 | NA | NA | NA | 51334 | 51335 | NA | 19.9 | 20.2 | 51365 | 18.25 | 51375 |

* Non-stock item



STANDARD KIT

Includes inserts, drill, tap, install tool and tang break

| E-Z LOK Kit Part No. | Thread Size | No. of Inserts | E-Z LOK Kit Part No. | Thread Size | No. of Inserts |
|----------------------|----------------|----------------|----------------------|-----------------|----------------|
| SK20215 | 4-40 x 1.5D | 10 | SK30815 | 1/4-28 x 1.5D | 10 |
| SK20315 | 5-40 x 1.5D | 10 | SK30915 | 5/16-24 x 1.5D | 10 |
| SK20415 | 6-32 x 1.5D | 10 | SK31015 | 3/8-24 x 1.5D | 10 |
| SK20515 | 8-32 x 1.5D | 10 | SK40215 | M3-0.5 x 1.5D | 10 |
| SK20615 | 10-24 x 1.5D | 10 | SK40315 | M3.5-0.6 x 1.5D | 10 |
| SK20715 | 12-24 x 1.5D | 10 | SK40415 | M4-0.7 x 1.5D | 10 |
| SK20815 | 1/4-20 x 1.5D | 10 | SK40515 | M5-0.8 x 1.5D | 10 |
| SK20915 | 5/16-18 x 1.5D | 10 | SK40615 | M6-1.0 x 1.5D | 10 |
| SK21015 | 3/8-16 x 1.5D | 10 | SK40715 | M7-1.0 x 1.5D | 10 |
| SK30215 | 4-48 x 1.5D | 10 | SK40815 | M8-1.25 x 1.5D | 10 |
| SK30415 | 6-40 x 1.5D | 10 | SK40915 | M10-1.5 x 1.5D | 10 |
| SK30515 | 8-36 x 1.5D | 10 | SK50815 | M8-1.0 x 1.5D | 10 |
| SK30615 | 10-32 x 1.5D | 10 | SK50915 | M10-1.25 x 1.5D | 10 |

Kits with 1D or 2D lengths available on request



ECONOMY KIT

Includes inserts, tap and install tool.

| E-Z LOK Kit Part No. | Thread Size | No. of Inserts | E-Z LOK Kit Part No. | Thread Size | No. of Inserts |
|----------------------|----------------|----------------|----------------------|-----------------|----------------|
| EK20015 | 2-56 x 1.5D | 10 | EK31315 | 9/16-18 x 1.5D | 5 |
| EK20115 | 3-48 x 1.5D | 10 | EK31415 | 5/8-18 x 1.5D | 5 |
| EK20215 | 4-40 x 1.5D | 10 | EK31515 | 3/4-16 x 1.5D | 5 |
| EK20315 | 5-40 x 1.5D | 10 | EK40215 | M3-0.5 x 1.5D | 10 |
| EK20415 | 6-32 x 1.5D | 10 | EK40315 | M3.5-0.6 x 1.5D | 10 |
| EK20515 | 8-32 x 1.5D | 10 | EK40415 | M4-0.7 x 1.5D | 10 |
| EK20615 | 10-24 x 1.5D | 10 | EK40515 | M5-0.8 x 1.5D | 10 |
| EK20715 | 12-24 x 1.5D | 10 | EK40615 | M6-1.0 x 1.5D | 10 |
| EK20815 | 1/4-20 x 1.5D | 10 | EK40715 | M7-1.0 x 1.5D | 10 |
| EK20915 | 5/16-18 x 1.5D | 10 | EK40815 | M8-1.25 x 1.5D | 10 |
| EK21015 | 3/8-16 x 1.5D | 10 | EK40915 | M10-1.5 x 1.5D | 10 |
| EK21115 | 7/16-14 x 1.5D | 5 | EK42215 | M11-1.5 x 1.5D | 5 |
| EK21215 | 1/2-13 x 1.5D | 5 | EK41015 | M12-1.75 x 1.5D | 5 |
| EK21315 | 9/16-12 x 1.5D | 5 | EK41115 | M14-2.0 x 1.5D | 5 |
| EK21415 | 5/8-11 x 1.5D | 5 | EK41215 | M16-2.0 x 1.5D | 5 |
| EK21515 | 3/4-10 x 1.5D | 5 | EK41315 | M18-2.5 x 1.5D | 5 |
| EK30215 | 4-48 x 1.5D | 10 | EK41415 | M20-2.5 x 1.5D | 5 |
| EK30415 | 6-40 x 1.5D | 10 | EK50815 | M8-1.0 x 1.5D | 10 |
| EK30515 | 8-36 x 1.5D | 10 | EK50915 | M10-1.25 x 1.5D | 10 |
| EK30615 | 10-32 x 1.5D | 10 | EK51015 | M12-1.5 x 1.5D | 5 |
| EK30815 | 1/4-28 x 1.5D | 10 | EK51115 | M14-1.5 x 1.5D | 5 |
| EK30915 | 5/16-24 x 1.5D | 10 | EK51215 | M16-1.5 x 1.5D | 5 |
| EK31015 | 3/8-24 x 1.5D | 10 | EK51315 | M18-2.0 x 1.5D | 5 |
| EK31115 | 7/16-20 x 1.5D | 5 | EK51415 | M20-2.0 x 1.5D | 5 |
| EK31215 | 1/2-20 x 1.5D | 5 | | | |

Kits with 1D or 2D lengths available on request



UNIFIED

| For Use With: | Drills Drill Size | Drills Part No. | STI Taps Part No. | Install Tools Part No. | Tang Break Part No. |
|-------------------------|-------------------|-----------------|-------------------|------------------------|---------------------|
| UNIFIED – COARSE | | | | | |
| 2-56 | 3/32 | 20060 | 20070 | M1002 | T2002 |
| 3-48 | #36 | 20160 | 20170 | M1003 | T2002 |
| 4-40 | #31 | A0260 | 20270 | M1004 | T2004 |
| 5-40 | #29 | 20360 | 20370 | M1004 | T2004 |
| 6-32 | #25 | A0460 | 20470 | M1005 | T2005 |
| 8-32 | 11/64 | A0560 | 20570 | M1006 | T2006 |
| 10-24 | 13/64 | A0660 | 20670 | M1007 | T2008 |
| 12-24 | 15/64 | 20760 | 20770 | M1008 | T2008 |
| 1/4-20 | 17/64 | A0860 | 20870 | M1009 | T2009 |
| 5/16-18 | 21/64 | A0960 | 20970 | M1010 | T2010 |
| 3/8-16 | 25/64 | A1060 | 21070 | M1012 | T2012 |
| 7/16-14 | 29/64 | A1160 | 21170 | M1014 | T2014 |
| 1/2-13 | 33/64 | A1260 | 21270 | M1015 | T2015 |
| 9/16-12 | 37/64 | A1360 | 21370 | M1016 | T2015 |
| 5/8-11 | 21/32 | 21460 | 21470 | M1018 | - |
| 3/4-10 | 25/32 | 21560 | 21570 | M1020 | - |
| 7/8-9 | 29/32 | 21660 | 26170 | M1022 | - |
| 1-8 | 1-1/32 | 21760 | 21770 | M1023 | - |
| 1-1/8-7 | 1-5/32 | A1860 | 21870 | M1024 | - |
| 1-1/4-7 | 1-9/32 | A1960 | 21970 | M1025 | - |
| 1-3/8-6 | 1-13/32 | A2060 | 22070 | M1026 | - |
| 1-1/2-6 | 1-17/32 | A2160 | 22170 | M1027 | - |
| UNIFIED – FINE | | | | | |
| 4-48 | #31 | A0260 | 30270 | M1004 | T2004 |
| 6-40 | #25 | A0460 | 30470 | M1005 | T2005 |
| 8-36 | 11/64 | A0560 | 30570 | M1006 | T2006 |
| 10-32 | 13/64 | A0660 | 30670 | M1008 | T2008 |
| 1/4-28 | 17/64 | A0860 | 30870 | M1009 | T2009 |
| 5/16-24 | 21/64 | A0960 | 30970 | M1011 | T2011 |
| 3/8-24 | 25/64 | A1060 | 31070 | M1013 | T2013 |
| 7/16-20 | 29/64 | A1160 | 31170 | M1014 | T2014 |
| 1/2-20 | 33/64 | A1260 | 31270 | M1015 | T2015 |
| 9/16-18 | 37/64 | A1360 | 31370 | M1016 | T2015 |
| 5/8-18 | 41/64 | 31460 | 31470 | M1018 | - |
| 3/4-16 | 49/64 | 31560 | 31570 | M1021 | - |
| 7/8-14 | 57/64 | 31660 | 31670 | M1022 | - |
| 1-14 | 1-1/64 | 31760 | 31770 | M1023 | - |
| 1-12 | 1-1/64 | 31760 | 32270 | M1023 | - |
| 1-1/8-12 | 1-5/32 | A1860 | 31870 | M1028 | - |
| 1-1/4-12 | 1-9/32 | A1960 | 31970 | M1029 | - |
| 1-3/8-12 | 1-13/32 | A2060 | 32070 | M1030 | - |
| 1-1/2-12 | 1-17/32 | A2160 | 32170 | M1031 | - |

METRIC

| For Use With: | Drills Drill Size | Drills Part No. | STI Taps Part No. | Install Tools Part No. | Tang Break Part No. |
|------------------------|-------------------|-----------------|-------------------|------------------------|---------------------|
| METRIC – COARSE | | | | | |
| M2-0.4 | 2.1mm | 40060 | 40070 | M1002 | T2002 |
| M2.5-.45 | 2.6mm | 40160 | 40170 | M1002 | T2002 |
| M3-0.5 | 3.1mm | 40260 | 40270 | M1004 | T2004 |
| M3.5-0.6 | 3.6mm | 40360 | 40370 | M1005 | T2005 |
| M4-0.7 | 4.1mm | 40460 | 40470 | M1006 | T2006 |
| M5-0.8 | 5.2mm | 40560 | 40570 | M1008 | T2008 |
| M6-1.0 | 6.2mm | 40660 | 40670 | M1009 | T2009 |
| M7-1.0 | 7.2mm | 40760 | 40770 | M1010 | T2010 |
| M8-1.25 | 8.3mm | E0860 | 40870 | M1011 | T2011 |
| M10-1.5 | 10.3mm | E0960 | 40970 | M1013 | T2013 |
| M11-1.5 | 11.3mm | 42260 | 42270 | M1014 | T2014 |
| M12-1.75 | 12.4mm | E1060 | 41070 | M1015 | T2015 |
| M14-2.0 | 14.5mm | 41160 | 41170 | M1016 | T2015 |
| M16-2.0 | 16.50mm | 41260 | 41270 | M1018 | - |
| M18-2.5 | 18.50mm | E1360 | 41370 | M1020 | - |
| M20-2.5 | 20.50mm | E1460 | 41470 | M1021 | - |
| M22-2.5 | 22.50mm | E1560 | 41570 | M1022 | - |
| M24-3.0 | 24.75mm | 41660 | 41670 | M1023 | - |
| M27-3.0 | 27.50mm | 41760 | 41770 | M1032 | - |
| M30-3.5 | 30.50mm | 41860 | 41870 | M1033 | - |
| M33-3.5 | 33.50mm | 41960 | 41970 | M1034 | - |
| M36-4.0 | 36.50mm | 42060 | 42070 | M1035 | - |
| M39-4.0 | 39.50mm | 42160 | 42170 | M1036 | - |
| METRIC – FINE | | | | | |
| M8-1.0 | 8.3mm | E0860 | 50870 | M1011 | T2011 |
| M10-1.25 | 10.3mm | E0960 | 50970 | M1013 | T2013 |
| M12-1.5 | 12.4mm | E1060 | 51070 | M1015 | T2015 |
| M14-1.5 | 14.30mm | E1160 | 51170 | M1016 | T2015 |
| M16-1.5 | 16.25mm | 51260 | 51270 | M1018 | - |
| M18-2.0 | 18.50mm | E1360 | 51370 | M1020 | - |
| M20-2.0 | 20.50mm | E1460 | 51470 | M1020 | - |
| M22-2.0 | 22.50mm | E1560 | 51570 | M1021 | - |
| M24-2.0 | 24.25mm | 51660 | 51670 | M1022 | - |
| SPARK PLUG | | | | | |
| M10-1.0 | 10.3mm | E0960 | 50975 | M1013 | T2013 |
| M12-1.25 | 12.4mm | E1060 | 51075 | M1015 | T2015 |
| M14-1.25 | 14.30mm | E1160 | 51175 | M1017 | T2015 |
| M18-1.5 | 18.25mm | 51365 | 51375 | M1020 | - |



ULTRASONIC INSERTS—TAPERED

DESIGNED FOR USE IN THERMOPLASTICS

- TAPERED DESIGN REDUCES INSTALLATION TIME
- INSTALL ULTRASONICALLY OR WITH HEAT DRIVER
- SUPERIOR TORQUE/PULL OUT RESISTANCE
- UNC AND METRIC THREADS
- SINGLE AND DOUBLE VANE



TAPERED SINGLE VANE

| Part Number. | Internal Thread | Overall Length (L) | Insert Diameter (W) | Pilot Diameter (N) | Rec. Hole Size* (D) | Rec. Hole Size* (S) | Minimum Wall Thickness |
|--------------|-----------------|--------------------|---------------------|--------------------|---------------------|---------------------|------------------------|
| TH-002-SV | 2-56 | .115 | .136 | .122 | .123 | .118 | .080 |
| TH-004-SV | 4-40 | .135 | .172 | .157 | .159 | .153 | .093 |
| TH-006-SV | 6-32 | .150 | .220 | .203 | .206 | .199 | .116 |
| TH-008-SV | 8-32 | .185 | .250 | .230 | .234 | .226 | .133 |
| TH-124-SV | 10-24 | .225 | .296 | .272 | .277 | .267 | .159 |
| TH-132-SV | 10-32 | .225 | .296 | .272 | .277 | .267 | .159 |
| TH-420-SV | 1/4-20 | .300 | .375 | .354 | .363 | .349 | .194 |
| TH-428-SV | 1/4-28 | .300 | .375 | .354 | .363 | .349 | .194 |
| TH-518-SV | 5/16-18 | .335 | .469 | .439 | .448 | .431 | .245 |
| TH-316-SV | 3/8-16 | .375 | .563 | .530 | .540 | .523 | .293 |
| TH-324-SV | 3/8-24 | .375 | .563 | .530 | .540 | .523 | .293 |
| TH-M25-SV | M2.5-0.4 | .135 | .172 | .157 | .159 | .153 | .093 |
| TH-M30-SV | M3-0.5 | .150 | .220 | .203 | .206 | .199 | .116 |
| TH-M40-SV | M4-0.7 | .185 | .250 | .230 | .234 | .226 | .133 |
| TH-M50-SV | M5-0.8 | .265 | .328 | .308 | .315 | .303 | .171 |
| TH-M60-SV | M6-1.0 | .300 | .375 | .354 | .363 | .349 | .194 |

* Hole size requirements may vary depending on a number of factors, including material and tools. We recommend that you test your particular application before ordering. We gladly supply free samples.

TAPERED DOUBLE VANE

| Part Number. | Internal Thread | Overall Length (L) | Insert Diameter (W) | Pilot Diameter (N) | Rec. Hole Size* (D) | Rec. Hole Size* (S) | Minimum Wall Thickness |
|--------------|-----------------|--------------------|---------------------|--------------------|---------------------|---------------------|------------------------|
| DV-002-TH | 2-56 | .188 | .136 | .115 | .123 | .107 | .080 |
| DV-004-TH | 4-40 | .219 | .172 | .144 | .159 | .141 | .093 |
| DV-006-TH | 6-32 | .250 | .220 | .190 | .206 | .185 | .116 |
| DV-008-TH | 8-32 | .312 | .250 | .212 | .234 | .208 | .133 |
| DV-124-TH | 10-24 | .375 | .297 | .251 | .277 | .246 | .159 |
| DV-132-TH | 10-32 | .375 | .297 | .251 | .277 | .246 | .159 |
| DV-420-TH | 1/4-20 | .500 | .375 | .332 | .363 | .321 | .194 |
| DV-428-TH | 1/4-28 | .500 | .375 | .332 | .363 | .321 | .194 |
| DV-518-TH | 5/16-18 | .562 | .469 | .406 | .448 | .401 | .245 |
| DV-316-TH | 3/8-16 | .625 | .563 | .493 | .540 | .488 | .293 |
| DV-M25-TH | M2.5-0.4 | .219 | .172 | .144 | .159 | .141 | .093 |
| DV-M30-TH | M3-0.5 | .250 | .220 | .190 | .206 | .185 | .116 |
| DV-M40-TH | M4-0.7 | .312 | .250 | .212 | .234 | .208 | .133 |
| DV-M50-TH | M5-0.8 | .438 | .328 | .283 | .315 | .278 | .171 |
| DV-M60-TH | M6-1.0 | .500 | .375 | .332 | .363 | .321 | .194 |

* Hole size requirements may vary depending on a number of factors, including material and tools. We recommend that you test your particular application before ordering. We gladly supply free samples.

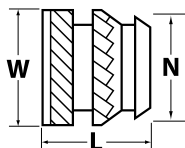

Single Vane

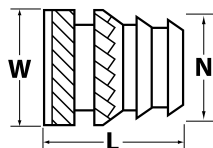

Double Vane

Hole depth should be a minimum of .030" greater than the length of the insert in blind holes.

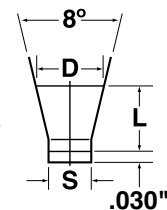



ULTRASONIC INSERTS—STRAIGHT

DESIGNED FOR USE IN THERMOPLASTICS

- STRAIGHT DESIGN PERMITS THINNER BOSS WALLS
- INSTALL ULTRASONICALLY OR WITH HEAT DRIVER
- SUPERIOR TORQUE/PULL OUT RESISTANCE
- FLUSH AND FLANGED DESIGNS



STRAIGHT FLUSH

| Part Number. | Internal Thread | Overall Length (L) | Insert Diameter (W) | Head Diameter (H) | Pilot Diameter (N) | Rec. Hole Size* | Minimum Wall Thickness |
|--------------|-----------------|--------------------|---------------------|-------------------|--------------------|-----------------|------------------------|
| HI-002-WH | 2-56 | .157 | .141 | N/A | .123 | .126 | .051 |
| HI-004-WH | 4-40 | .226 | .181 | N/A | .154 | .157 | .063 |
| HI-006-WH | 6-32 | .281 | .214 | N/A | .185 | .189 | .071 |
| HI-008-WH | 8-32 | .321 | .248 | N/A | .218 | .220 | .083 |
| HI-124-WH | 10-24 | .375 | .278 | N/A | .249 | .252 | .102 |
| HI-132-WH | 10-32 | .375 | .278 | N/A | .249 | .252 | .102 |
| HI-420-WH | 1/4-20 | .500 | .341 | N/A | .312 | .315 | .130 |
| HI-428-WH | 1/4-28 | .500 | .341 | N/A | .312 | .315 | .130 |
| HI-518-WH | 5/16-18 | .500 | .403 | N/A | .374 | .378 | .177 |
| HI-524-WH | 5/16-24 | .500 | .403 | N/A | .374 | .378 | .177 |
| HI-316-WH | 3/8-16 | .500 | .494 | N/A | .465 | .469 | .236 |
| HI-324-WH | 3/8-24 | .500 | .494 | N/A | .465 | .469 | .236 |

* Hole size requirements may vary depending on a number of factors, including material and tools. We recommend that you test your particular application before ordering. We gladly supply free samples. "

STRAIGHT FLANGED

| Part Number. | Internal Thread | Overall Length (L+T) | Insert Diameter (W) | Head Diameter (H) | Pilot Diameter (N) | Rec. Hole Size* | Minimum Wall Thickness |
|--------------|-----------------|----------------------|---------------------|-------------------|--------------------|-----------------|------------------------|
| FL-256-HI | 2-56 | .178 | .141 | .187 | .123 | .126 | .051 |
| FL-440-HI | 4-40 | .250 | .181 | .218 | .154 | .157 | .063 |
| FL-632-HI | 6-32 | .311 | .214 | .250 | .185 | .189 | .071 |
| FL-832-HI | 8-32 | .357 | .248 | .281 | .218 | .220 | .083 |
| FL-124-HI | 10-24 | .418 | .278 | .312 | .249 | .252 | .102 |
| FL-132-HI | 10-32 | .418 | .278 | .312 | .249 | .252 | .102 |
| FL-420-HI | 1/4-20 | .553 | .341 | .375 | .312 | .315 | .130 |
| FL-428-HI | 1/4-28 | .553 | .341 | .375 | .312 | .315 | .130 |
| FL-518-HI | 5/16-18 | .553 | .403 | .437 | .374 | .378 | .177 |
| FL316-HI | 3/8-16 | .563 | .494 | .551 | .465 | .469 | .236 |

* Hole size requirements may vary depending on a number of factors, including material and tools. We recommend that you test your particular application before ordering. We gladly supply free samples.

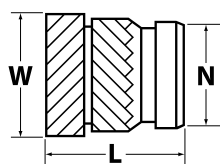

Flush

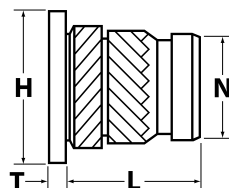

Flanged



FOR CORED OR DRILLED HOLES IN PLASTIC

Diamond-knurled press inserts are designed to replace molded-in inserts and threads in thermoset plastics.

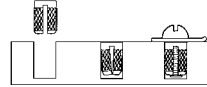

- INSTALL COLD
- SHARPLY REDUCE THE COST OF MOLDINGS
- CUT REJECT WASTE CAUSED BY MISALIGNED AND FAULTY INSERTS
- ELIMINATE THE NEED TO "CHASE" THREADS AFTER MOLDING
- INSTALL PROPERLY WITHOUT A PRECISE HOLE DEPTH

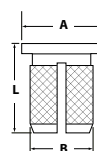
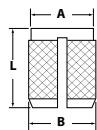
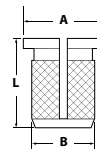
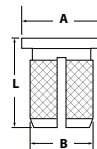
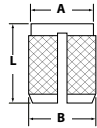

* Hole size requirements may vary depending on a number of factors, including material and tools. We recommend that you test your particular application before ordering. We gladly supply free samples.

BRASS — FLUSH

| EZ-LOK Part No. | Internal Thread | A ±.010" | B ±.010" | L ±.010" | Starting Hole Size* |
|-----------------|-----------------|-------------|-------------|-------------|---------------------|
| 240-000-BR | 0-80 | .094 | .104 | .125 | .094 (3/32) |
| 240-002-BR | 2-56 | .125 | .135 | .156 | .125 (1/8) |
| 240-004-BR | 4-40 | .156 | .166 | .188 | .156 (5/32) |
| 240-006-BR | 6-32 | .187 | .199 | .250 | .188 (3/16) |
| 240-008-BR.250 | 8-32 | .218 | .230 | .250 | .219 (7/32) |
| 240-008-BR | 8-32 | .218 | .230 | .313 | .219 (7/32) |
| 240-332-BR.250 | 10-32 | .250 | .262 | .250 | .250 (1/4) |
| 240-332-BR | 10-32 | .250 | .262 | .375 | .250 (1/4) |
| 240-3-BR | 10-24 | .250 | .262 | .375 | .250 (1/4) |
| 240-4-BR | 1/4-20 | .312 | .326 | .500 | .313 (5/16) |
| 240-5-BR | 5/16-18 | .375 | .389 | .563 | .375 (3/8) |
| 240-6-BR | 3/8-16 | .437 | .451 | .625 | .438 (7/16) |
| 240-M3-BR | M3-0.5 | .156 | .166 | .188 | .156 (5/32) |
| 240-M3.5-BR | M3.5-0.6 | .187 | .199 | .250 | .188 (3/16) |
| 240-M4-BR | M4-0.7 | .218 | .230 | .313 | .219 (7/32) |
| 240-M5-BR | M5-0.8 | .250 | .262 | .375 | .250 (1/4) |
| 240-M6-BR | M6-1.0 | .312 | .326 | .500 | .313 (5/16) |

BRASS — FLANGED

| EZ-LOK Part No. | Internal Thread | A ±.010" | B ±.010" | L ±.010" | Starting Hole Size* |
|-----------------|-----------------|-------------|-------------|-------------|---------------------|
| 260-002-BR | 2-56 | .187 | .135 | .156 | .125 (1/8) |
| 260-004-BR | 4-40 | .218 | .166 | .188 | .156 (5/32) |
| 260-006-BR | 6-32 | .249 | .199 | .250 | .188 (3/16) |
| 260-008-BR | 8-32 | .280 | .230 | .313 | .219 (7/32) |
| 260-332-BR | 10-32 | .312 | .262 | .375 | .250 (1/4) |
| 260-4-BR | 1/4-20 | .375 | .326 | .500 | .313 (5/16) |
| 260-5-BR | 5/16-18 | .437 | .389 | .563 | .375 (3/8) |
| 260-6-BR | 3/8-16 | .500 | .451 | .625 | .438 (7/16) |

BRASS — FLANGED — REVERSED SLOT

| EZ-LOK Part No. | Internal Thread | A ±.010" | B ±.010" | L ±.010" | Starting Hole Size* |
|-----------------|-----------------|-------------|-------------|-------------|---------------------|
| 260-002-RS | 2-56 | .187 | .135 | .156 | .125 (1/8) |
| 260-004-RS | 4-40 | .218 | .166 | .188 | .156 (5/32) |
| 260-006-RS | 6-32 | .249 | .199 | .250 | .188 (3/16) |
| 260-008-RS | 8-32 | .280 | .230 | .313 | .219 (7/32) |
| 260-332-RS | 10-32 | .312 | .262 | .375 | .250 (1/4) |
| 260-4-RS | 1/4-20 | .375 | .326 | .500 | .313 (5/16) |

STAINLESS STEEL — FLUSH

| EZ-LOK Part No. | Internal Thread | A ±.010" | B ±.010" | L ±.010" | Starting Hole Size* |
|-----------------|-----------------|-------------|-------------|-------------|---------------------|
| 240-002-CR | 2-56 | .125 | .135 | .156 | .125 (1/8) |
| 240-004-CR | 4-40 | .156 | .166 | .188 | .156 (5/32) |
| 240-006-CR | 6-32 | .187 | .199 | .250 | .188 (3/16) |
| 240-008-CR | 8-32 | .218 | .230 | .313 | .219 (7/32) |
| 240-332-CR | 10-32 | .250 | .262 | .375 | .250 (1/4) |
| 240-4-CR | 1/4-20 | .312 | .326 | .500 | .313 (5/16) |
| 240-5-CR | 5/16-18 | .375 | .389 | .563 | .375 (3/8) |
| 240-6-CR | 3/8-16 | .437 | .451 | .625 | .438 (7/16) |

STAINLESS STEEL — FLANGED

| EZ-LOK Part No. | Internal Thread | A ±.010" | B ±.010" | L ±.010" | Starting Hole Size* |
|-----------------|-----------------|-------------|-------------|-------------|---------------------|
| 260-002-CR | 2-56 | .187 | .135 | .156 | .125 (1/8) |
| 260-004-CR | 4-40 | .218 | .166 | .188 | .156 (5/32) |
| 260-006-CR | 6-32 | .249 | .199 | .250 | .188 (3/16) |
| 260-008-CR | 8-32 | .280 | .230 | .313 | .219 (7/32) |
| 260-332-CR | 10-32 | .312 | .262 | .375 | .250 (1/4) |
| 260-4-CR | 1/4-20 | .375 | .326 | .500 | .313 (5/16) |

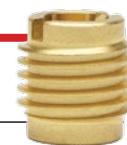

External knife threads provide superior holding power in hard and soft woods, particle board and all wood products. Use wherever field assembly or disassembly could lead to thread erosion or stripping. The long pilot ensures straight driving into a drilled hole. Install with screwdriver, bolt and nut, tapping head, or E-Z LOK driving tool.



BRASS KNIFE THREAD INSERTS — FOR WOOD

| EZ-LOK Part No. | Internal Thread | Length | Major Diameter External Thread | Hole* Size | Drive Tool Catalog Number |
|-----------------|-----------------|--------|--------------------------------|------------|---------------------------|
| 400-004 | 4-40 | .375 | .328 | 1/4" | — |
| 400-006 | 6-32 | .375 | .328 | 1/4" | 500-006 |
| 400-008 | 8-32 | .375 | .328 | 1/4" | 500-1 |
| 400-3 | 10-24 | .500 | .453 | 3/8" | 500-2 |
| 400-332 | 10-32 | .500 | .453 | 3/8" | 500-2 |
| 400-4 | 1/4-20 | .500 | .453 | 3/8" | 500-3 |
| 400-428 | 1/4-28 | .500 | .453 | 3/8" | 500-3 |
| 400-5 | 5/16-18 | .625 | .593 | 1/2" | 500-4 |
| 400-524 | 5/16-24 | .625 | .593 | 1/2" | 500-4 |
| 400-6 | 3/8-16 | .625 | .593 | 1/2" | 500-5 |
| 400-624 | 3/8-24 | .625 | .593 | 1/2" | 500-5 |
| 400-M3 | M3-0.5 | .375 | .328 | 1/4" | 500-006 |
| 400-M4 | M4-0.7 | .375 | .328 | 1/4" | 500-1 |
| 400-M5 | M5-0.8 | .500 | .453 | 3/8" | 500-2 |
| 400-M6 | M6-1.0 | .500 | .453 | 3/8" | 500-3 |
| 400-M8 | M8-1.25 | .625 | .593 | 1/2" | 500-4 |

STAINLESS STEEL KNIFE THREAD INSERTS — FOR WOOD

| EZ-LOK Part No. | Internal Thread | Length | Major Diameter External Thread | Hole* Size | Drive Tool Catalog Number |
|-----------------|-----------------|--------|--------------------------------|------------|---------------------------|
| 400-008-CR | 8-32 | .375 | .328 | 1/4" | 500-1 |
| 400-3-CR | 10-24 | .500 | .453 | 3/8" | 500-2 |
| 400-4-CR | 1/4-20 | .500 | .453 | 3/8" | 500-3 |

*Hole size requirements may vary depending on material and tools. We recommend that you test before ordering. We gladly supply free samples.

DIE CAST ZINC ALLOY HEXDRIVE THREAD INSERTS — FOR WOOD

| EZ-LOK Part No. | Design | Internal Thread | Length | Hole* Size | Hex Dimensions | Drive Tool. Catalog Number |
|-----------------|---------|-----------------|--------|------------|----------------|----------------------------|
| 800832-10 | Flush | 8-32 | 10mm | 6mm | M4 | 8500 |
| 801024-13 | Flush | 10-24 | 13mm | 7mm | M5 | 8600 |
| 801032-13 | Flush | 10-32 | 13mm | 7mm | M5 | 8600 |
| 801420-13 | Flush | 1/4-20 | 13mm | 9mm | M6 | 9000 |
| 801420-20 | Flush | 1/4-20 | 20mm | 9mm | M6 | 9000 |
| 851618-20 | Flush | 5/16-18 | 20mm | 11mm | M8 | 9100 |
| 851618-25 | Flush | 5/16-18 | 25mm | 11mm | M8 | 9100 |
| 800610-13 | Flush | M6-1.0 | 13mm | 9mm | M6 | 9000 |
| 800610-20 | Flush | M6-1.0 | 20mm | 9mm | M6 | 9000 |
| 808125-13 | Flush | M8-1.25 | 13mm | 11mm | M8 | 9100 |
| 808125-20 | Flush | M8-1.25 | 20mm | 11mm | M8 | 9100 |
| 900832-10 | Flanged | 8-32 | 10mm | 6mm | M4 | 8500 |
| 901024-11 | Flanged | 10-24 | 11mm | 7mm | M5 | 8600 |
| 901024-20 | Flanged | 10-24 | 20mm | 7mm | M5 | 8600 |
| 901032-11 | Flanged | 10-32 | 11mm | 7mm | M5 | 8600 |
| 901032-13 | Flanged | 10-32 | 13mm | 7mm | M5 | 8600 |
| 901032-20 | Flanged | 10-32 | 20mm | 7mm | M5 | 8600 |
| 901420-13 | Flanged | 1/4-20 | 13mm | 9mm | M6 | 9000 |
| 901420-20 | Flanged | 1/4-20 | 20mm | 9mm | M6 | 9000 |
| 901420-25 | Flanged | 1/4-20 | 25mm | 9mm | M6 | 9000 |
| 951618-13 | Flanged | 5/16-18 | 13mm | 11mm | M8 | 9100 |
| 951618-25 | Flanged | 5/16-18 | 25mm | 11mm | M8 | 9100 |
| 903816-13 | Flanged | 3/8-16 | 13mm | 12mm | M10 | 9200 |
| 903816-25 | Flanged | 3/8-16 | 25mm | 12mm | M10 | 9200 |
| 900610-13 | Flanged | M6-1.0 | 13mm | 9mm | M6 | 9000 |
| 900610-20 | Flanged | M6-1.0 | 20mm | 9mm | M6 | 9000 |
| 908125-13 | Flanged | M8-1.25 | 13mm | 11mm | M8 | 9100 |
| 908125-20 | Flanged | M8-1.25 | 20mm | 11mm | M8 | 9100 |

*Hole size requirements may vary depending on material and tools. We recommend that you test before ordering. We gladly supply free samples.



An inexpensive insert for use in ready-to-assemble furniture, drawer pulls and wherever ease of assembly or avoidance of thread stripping is desired. Install with hex drive wrench or E-Z LOK drive tool.



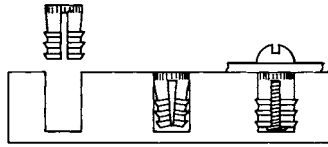

Fininserts provide strong metal threads in wood, composition board and thermoplastics such as nylon, polystyrene, cellulose acetate and cycloac. By distributing stress over a greater surface area, firm permanent fastening is ensured. The fins give higher holding strength in softer materials. Available with one, two or three fins for varying material thickness, Fininserts prevent splintering, splitting and thread pullout.

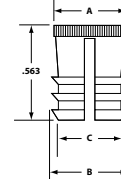
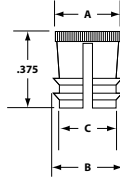
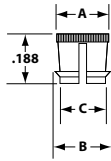

170 SERIES

170-006, 170-008, 170-332

270 SERIES

270-006, 270-008, 270-332, 270-3, 270-4

370 SERIES

370-332, 370-4, 370-5

| Thread Size | Dash Number | A | B | C | Starting Hole Size | A | B | C | Starting Hole Size | A | B | C | Starting Hole Size |
|-------------|-------------|------|------|------|--------------------|------|------|------|--------------------|------|------|------|--------------------|
| 6-32 | —006 | .210 | .237 | .189 | .205 (#5) | .210 | .237 | .189 | .205 (#5) | — | — | — | — |
| 8-32 | —008 | .236 | .263 | .215 | .234 (15/64) | .236 | .263 | .215 | .234 (15/64) | — | — | — | — |
| 10-32 | —332 | .263 | .290 | .242 | .261 (G) | .263 | .290 | .242 | .261 (G) | .347 | .368 | .318 | .344 (11/32) |
| 10-24 | —3 | — | — | — | — | .263 | .290 | .242 | .261 (G) | — | — | — | — |
| 1/4-20 | —4 | — | — | — | — | .330 | .357 | .309 | .328 (21/64) | .409 | .431 | .381 | .406 (13/32) |
| 5/16-18 | —5 | — | — | — | — | — | — | — | — | .471 | .493 | .443 | .469 (15/32) |



240 E. Rosecrans Ave. • Gardena, CA 90248
 (800) 234-5613 • Fx (310) 535-4444
www.ezlok.com • sales@ezlok.com